

Magnolia Drive Multi-Use Trail Community Meeting South Monroe Street to Apalachee Parkway Design Review

Hartfield Elementary School
Cafeteria
1414 Chowkeebin Nene
Monday, November 6, 2017 5:30 p.m.

Please provide your comments below. If more space is needed, please use an additional sheet of paper. You may place your comments in the "Comment Box" provided at the meeting, or send to Susan Emmanuel at the address below by November 16, 2017. Emailed comments are also acceptable to Susan.Emmanuel@BlueprintIA.org. NOTICE: Comments submitted are a matter of public record subject to examination by the general public upon request.

I like the 4' buffer/8' trail

Name Bill Bodiford
Address 1818 Atapha Nene
City, State, Zip Tallahassee, FL 32301
Phone Number _____
Email bodifordbill@gmail.com

Mail to:

Susan Emmanuel
Blueprint IA
315 S. Calhoun Street, Suite 450
Tallahassee, FL 32301

RE: Magnolia Dr. Multi-Use Trail

4' Buffer.
8-

no change

cyclists

no preference - just set 4' buffer

| |

||*A||

① no bike lanes
should use trail

② denys dangerous
for bikers

+ contrary to
AASHTO
Guidelines

- railing barrier @ high conflict pt
- detours impact business
- concerns re: schedule w/ many change
- plants not grass (2)
- 14' trail w/ 4' buffer
- low lighting

General comments

* B
A less cost
in row

(Bike)

consider bike lanes
on N/W Magnolia
base many cuts on
trail

- bury electric
- reduce speed 11
- avoid detours
- trail access @ each side st.
- sep. of trail + road not good for cyclists as they are less visible
- Circle @ Magnolia - move xwalk → north
- curb radii tight

* Access Road Closure Concerns 11

Magnolia Drive Multi-Use Trail Community Meeting South Monroe Street to Apalachee Parkway Design Review

Hartfield Elementary School
Cafeteria
1414 Chowkeebin Nene
Monday, November 6, 2017 5:30 p.m.

Please provide your comments below. If more space is needed, please use an additional sheet of paper. You may place your comments in the "Comment Box" provided at the meeting, or send to Susan Emmanuel at the address below by November 16, 2017. Emailed comments are also acceptable to Susan.Emmanuel@BlueprintIA.org. NOTICE: Comments submitted are a matter of public record subject to examination by the general public upon request.

Please build this road on the assumption that cyclists will use the multi-use trail, not the roadway. I would rather you did not allow for bike lanes, thus allowing the roadway width to be less, and perhaps allowing for a 10-foot trail with a four-foot buffer

Richard Hopkins
Name
1209 Camellia Dr.
Address
Tallahassee FL 32301
City, State, Zip
850-544-7614
Phone Number
hopkinsr@comcast.net
Email

Mail to:

Susan Emmanuel
Blueprint IA
315 S. Calhoun Street, Suite 450
Tallahassee, FL 32301

RE: Magnolia Dr. Multi-Use Trail

Magnolia Drive Multi-Use Trail Community Meeting South Monroe Street to Apalachee Parkway Design Review

Hartfield Elementary School
Cafeteria
1414 Chowkeebin Nene
Monday, November 6, 2017 5:30 p.m.

Please provide your comments below. If more space is needed, please use an additional sheet of paper. You may place your comments in the "Comment Box" provided at the meeting, or send to Susan Emmanuel at the address below by November 16, 2017. Emailed comments are also acceptable to Susan.Emmanuel@BlueprintIA.org. NOTICE: Comments submitted are a matter of public record subject to examination by the general public upon request.

I think 4 ft buffer + 8 ft trail
is a good compromise

reduced cost
aesthetics
min right of way encroachment

Name James W. Cook
Address 1514 Alpha Nene / 1509 E
Tall. Fl. 32301 Magnolia
City, State, Zip 510.6662
Phone Number 1Cook109995@comcast.NET
Email

Mail to:

Susan Emmanuel
Blueprint IA
315 S. Calhoun Street, Suite 450
Tallahassee, FL 32301

RE: Magnolia Dr. Multi-Use Trail

Magnolia Drive Multi-Use Trail Community Meeting South Monroe Street to Apalachee Parkway Design Review

Hartfield Elementary School
Cafeteria
1414 Chowkeebin Nene
Monday, November 6, 2017 5:30 p.m.

Please provide your comments below. If more space is needed, please use an additional sheet of paper. You may place your comments in the "Comment Box" provided at the meeting, or send to Susan Emmanuel at the address below by November 16, 2017. Emailed comments are also acceptable to Susan.Emmanuel@BlueprintIA.org. NOTICE: Comments submitted are a matter of public record subject to examination by the general public upon request.

I support:
* 8' trail w/ 4' buffer
* burying electrical utilities
* slowing down traffic on Magnolia
* avoiding detouring traffic
through neighborhood when Magnolia is closed

Doug Martin
Name
1312 Nancy Dr.
Address
Tallahassee, FL 32301
City, State, Zip
850-212-7447
Phone Number
martindouglas@gmail.com
Email

Mail to:

Susan Emmanuel
Blueprint IA
315 S. Calhoun Street, Suite 450
Tallahassee, FL 32301

RE: Magnolia Dr. Multi-Use Trail

Magnolia Drive Multi-Use Trail Community Meeting South Monroe Street to Apalachee Parkway Design Review

Hartfield Elementary School
Cafeteria
1414 Chowkeebin Nene
Monday, November 6, 2017 5:30 p.m.

Please provide your comments below. If more space is needed, please use an additional sheet of paper. You may place your comments in the "Comment Box" provided at the meeting, or send to Susan Emmanuel at the address below by November 16, 2017. Emailed comments are also acceptable to Susan.Emmanuel@BlueprintIA.org. NOTICE: Comments submitted are a matter of public record subject to examination by the general public upon request.

It is important to have the trail accessible for bikes and wheelchairs at every side road on the opposite side of the trail (Cuts in the curb)

Separation of the trail ~~to~~ from the main road negatively impacts safety for cyclists and joggers at intersections and driveways as it makes trail users less visible to turning traffic from Magnolia and cross traffic. It would be good to not have a buffer at intersections

Name Mans Van Tol
Address 1503 Old Fort Dr
Tallahassee, FL 32301
City, State, Zip 850 765 8050
Phone Number johavantol@yahoo.com
Email

Mail to:

Susan Emmanuel
Blueprint IA
315 S. Calhoun Street, Suite 450
Tallahassee, FL 32301

RE: Magnolia Dr. Multi-Use Trail

Magnolia Drive Multi-Use Trail Community Meeting South Monroe Street to Apalachee Parkway Design Review

Hartfield Elementary School
Cafeteria
1414 Chowkeebin Nene
Monday, November 6, 2017 5:30 p.m.

Please provide your comments below. If more space is needed, please use an additional sheet of paper. You may place your comments in the "Comment Box" provided at the meeting, or send to Susan Emmanuel at the address below by November 16, 2017. Emailed comments are also acceptable to Susan.Emmanuel@BlueprintIA.org. NOTICE: Comments submitted are a matter of public record subject to examination by the general public upon request.

- Very concerned about the speed of the traffic
- I'm distressed to hear that there is potential to close the access road to the New Leaf Shopping center area. The only way to get out of the shopping center easily is to take the access road if you want to go South on Magnolia - otherwise you have to go to the back of Olive Garden and use the traffic light. It's nearly impossible to get out near Cabos at 5:00 pm or busy times of day. We (in the neighborhood) use that Shopping Center regularly and see it's potential closure if you make less access to get out. We need a traffic light near Cabos.

Name Sally Schroder
Address 1405 Lola Drive
City, State, Zip Tallahassee Florida 32301
Phone Number (850) 228-2832
Email gneissgname@gmail.com

Mail to:

Susan Emmanuel
Blueprint IA
315 S. Calhoun Street, Suite 450
Tallahassee, FL 32301

RE: Magnolia Dr. Multi-Use Trail

Magnolia Drive Multi-Use Trail Community Meeting South Monroe Street to Apalachee Parkway Design Review

Hartfield Elementary School
Cafeteria
1414 Chowkeebin Nene
Monday, November 6, 2017 5:30 p.m.

Please provide your comments below. If more space is needed, please use an additional sheet of paper. You may place your comments in the "Comment Box" provided at the meeting, or send to Susan Emmanuel at the address below by November 16, 2017. Emailed comments are also acceptable to Susan.Emmanuel@BlueprintIA.org. NOTICE: Comments submitted are a matter of public record subject to examination by the general public upon request.

I AM A VERY STRONG SUPPORTER OF THE CONSTRUCTION OF
SIDEWALKS ON MAGNOLIA. I COMUTE TO WORK DAILY ON
A BIKE or ON FOOT AND KNOW THAT THE CONSTRUCTION WILL
INCREASE QUALITY OF LIFE AND MOBILITY AND COMMUNITY
CONNECTIVITY. OF THE RECENTLY PROPOSED PLANS I FEEL
THAT THE 8-FOOT TRAIL / 4-FOOT SIDEWALK IS
THE MOST BALANCED OPTION. THANK YOU FOR
SUPPORTING THE PROJECT.

ALEX MOSCA
Name
1917 S. MAGNOLIA DRIVE
Address
TALLAHASSEE, FL 32301
City, State, Zip
Phone Number
ALEX.MOSCA@GMAIL.COM
Email

Mail to:

Susan Emmanuel
Blueprint IA
315 S. Calhoun Street, Suite 450
Tallahassee, FL 32301

RE: Magnolia Dr. Multi-Use Trail

Magnolia Drive Multi-Use Trail Community Meeting South Monroe Street to Apalachee Parkway Design Review

Hartfield Elementary School
Cafeteria
1414 Chowkeebbin Nene
Monday, November 6, 2017 5:30 p.m.

Please provide your comments below. If more space is needed, please use an additional sheet of paper. You may place your comments in the "Comment Box" provided at the meeting, or send to Susan Emmanuel at the address below by November 16, 2017. Emailed comments are also acceptable to Susan.Emmanuel@BlueprintIA.org. NOTICE: Comments submitted are a matter of public record subject to examination by the general public upon request.

① At circle + Magnolia, cyclists use the light to connect from West to East + East to West. Coming from the west we can use the traffic lane. Coming from the east we use the sidewalk along Magnolia and wait for the pedestrian light. It is not ideal to cross on the south side of the intersection to continue heading west on the north side of circle.

② For cyclists: was a ~~sidewalk~~ bike lane considered on the north/west side of Magnolia, opposite the sidewalk on the south/east side? This section of magnolia (Apalachee to Monroe) has too many driveways + side roads to make it safe for cyclists to use. Unaware cyclists will ride the sidewalk and have a false sense of security

Marie-Claire Leman
Name
1911 Wabulaw Ct
Address
Tallahassee FL 32301
City, State, Zip
850 728-7514
Phone Number
marieclairelema@gmail.com
Email

Mail to:

Susan Emmanuel
Blueprint IA
315 S. Calhoun Street, Suite 450
Tallahassee, FL 32301

RE: Magnolia Dr. Multi-Use Trail

Magnolia Drive Multi-Use Trail Community Meeting South Monroe Street to Apalachee Parkway Design Review

Hartfield Elementary School
Cafeteria
1414 Chowkeebin Nene
Monday, November 6, 2017 5:30 p.m.

Please provide your comments below. If more space is needed, please use an additional sheet of paper. You may place your comments in the "Comment Box" provided at the meeting, or send to Susan Emmanuel at the address below by November 16, 2017. Emailed comments are also acceptable to Susan.Emmanuel@BlueprintIA.org. NOTICE: Comments submitted are a matter of public record subject to examination by the general public upon request.

- Please ensure curb radii @ intersections are as tight as possible, e.g. 25' ~~from~~ at actual internal curb radius.
- Please install low intensity, low height pedestrian lighting facilities, apx on 50' spacing.
- I prefer 14'-wide sidewalk or multipurpose trail facilities with 4' vegetative area back of curb (between sidewalk + curb) though it is more expensive.

Thanks

Name Adam Antony Biblo
Address 1316 Lehigh Drive
City, State, Zip Tallahassee, FL 32301
Phone Number this bib@comcast.net
Email

Mail to:

Susan Emmanuel
Blueprint IA
315 S. Calhoun Street, Suite 450
Tallahassee, FL 32301

RE: Magnolia Dr. Multi-Use Trail

**Magnolia Drive Multi-Use Trail Community Meeting
South Monroe Street to Apalachee Parkway
Design Review**

**Hartfield Elementary School
Cafeteria
1414 Chowkeebin Nene
Monday, November 6, 2017 5:30 p.m.**

Please provide your comments below. If more space is needed, please use an additional sheet of paper. You may place your comments in the "Comment Box" provided at the meeting, or send to Susan Emmanuel at the address below by November 16, 2017. Emailed comments are also acceptable to Susan.Emmanuel@BlueprintIA.org. NOTICE: Comments submitted are a matter of public record subject to examination by the general public upon request.

as far as 8' vs 10' trail, I think 8' is plenty. 10' is fine but I have concern it may be too time consuming to purchase the ROW needed.

No Grass please (i.e. please use low maintenance plants - like done along Lafayette St 😊)

Name Jennifer Vrynios
Address 1212 Cherokee Drive
Tallahassee, FL 32301
City, State, Zip (850) 694-8359
Phone Number jennifer.vrynios@gmail.com
Email

Mail to:

Susan Emmanuel
Blueprint IA
315 S. Calhoun Street, Suite 450
Tallahassee, FL 32301

RE: Magnolia Dr. Multi-Use Trail

**Magnolia Drive Multi-Use Trail Community Meeting
South Monroe Street to Apalachee Parkway
Design Review**

Attachment #5
Page 13 of 34

**Hartfield Elementary School
Cafeteria
1414 Chowkeebin Nene
Monday, November 6, 2017 5:30 p.m.**

Please provide your comments below. If more space is needed, please use an additional sheet of paper. You may place your comments in the "Comment Box" provided at the meeting, or send to Susan Emmanuel at the address below by November 16, 2017. Emailed comments are also acceptable to Susan.Emmanuel@BlueprintIA.org. NOTICE: Comments submitted are a matter of public record subject to examination by the general public upon request.

- During construction, please consider how detouring traffic may impact businesses on the corridor.
- I think that short shrubs or ground cover is a better option than simply grass for the buffer.
- Also consider metal railings as a barrier/buffer—especially in areas with a history of auto accidents.

Name Sian Doman
Address 1113 S. Magnolia Dr.
City, State, Zip _____
Phone Number _____
Email ✓

Mail to:

Susan Emmanuel
Blueprint IA
315 S. Calhoun Street, Suite 450
Tallahassee, FL 32301

RE: Magnolia Dr. Multi-Use Trail

Magnolia Drive Multi-Use Trail Community Meeting South Monroe Street to Apalachee Parkway Design Review

Hartfield Elementary School
Cafeteria
1414 Chowkeebin Nene
Monday, November 6, 2017 5:30 p.m.

Please provide your comments below. If more space is needed, please use an additional sheet of paper. You may place your comments in the "Comment Box" provided at the meeting, or send to Susan Emmanuel at the address below by November 16, 2017. Emailed comments are also acceptable to Susan.Emmanuel@BlueprintIA.org. NOTICE: Comments submitted are a matter of public record subject to examination by the general public upon request.

Please refer to my previous written comments re
design for bicycles, which were not addressed AT ALL.

Specifically: design is VERY dangerous for bicycles
and contrary to AASHTO guidelines

Edward Reed
Name
2014 W Indianhead Dr
Address
Talla. FL 32301
City, State, Zip
850 942 6877
Phone Number
edward@pedeo.org
Email

Mail to:

Susan Emmanuel
Blueprint IA
315 S. Calhoun Street, Suite 450
Tallahassee, FL 32301

RE: Magnolia Dr. Multi-Use Trail

I realize that pedestrian safety is important, but so are local businesses and chains that employ hundreds of people. Please take a minute and read this. It would be even better if you could find the time to come by the center around lunch.. Seeing what is already a problem with traffic flow in the center is worth a thousand words

I'm hoping BluePrint will recognize that 570,000 sq ft of retail space with 5 limited exits. 3 of which will be literally impossible to use with even more cars attempting to make lefts onto the eastbound lane of Lafayette, is going to be detrimental to all the tenants in the center..

Bottlenecks will get worse with all of them, including the already traffic backup with the exit/entrance onto South Magnolia. with people trying to get into the turn lane at South Magnolia and Lafayette to make the U Turn back up North..

The exit off the service road went a long way to afford people to make an easy transition to east lafayette , make a u-turn, at the light at lafayette, or simply make a right back onto lafayette without having to dodge traffic to do so, with the light stopping southbound traffic.

This has always been the safe way to get back onto the Magnolia or Lafayette.. The only exit back onto the parkway is on the extreme west side of the center and it is not equipped to handle the traffic even now.

The exit where Crispers is is right before Magnolia merges into 2 lanes and the traffic there has been aggressive, to put it mildly. Which will simply get worse when the service road exits are eliminated

The alley between Cabos and Ross is already a problem. .

I have a personal interest this as i have spent 30 years sustaining a business surrounded by dumpsters and no parking signs in an otherwise unrentable location, despite having no store front parking and a traffic jam almost all day and night .

Businesses that inconvenience people enough will go away.

Leave the light up where it is directing traffic on the service rd.
Located on east side of south Magnolia

Add a light on eastbound pkwy. With a "no turn on red" in the
proposed turning lane onto south magnolia.

That would give the service rd a chance to empty after the west
bound pkwy light green arrow goes red (like it does now)
(westbound pkwy turn off onto South Magnolia)

It would accomplish two things.

it would give the folks on the service rd a chance to turn and it
would alleviate a huge potential mess with those southbound on
magnolia trying to get into an already congested mess turning into
the center with people turning left on the proposed east exit ..

i know this sounds like the "who's on first skit," but it would work.

pedestrians would be protected by traffic lights just like they are
when crossing the parkway.....

MIKE FERRARA
1.850.566.1444
owner Cabos Island Grill Bar
Pkwy corner.
cabos-tacos@yahoo.com

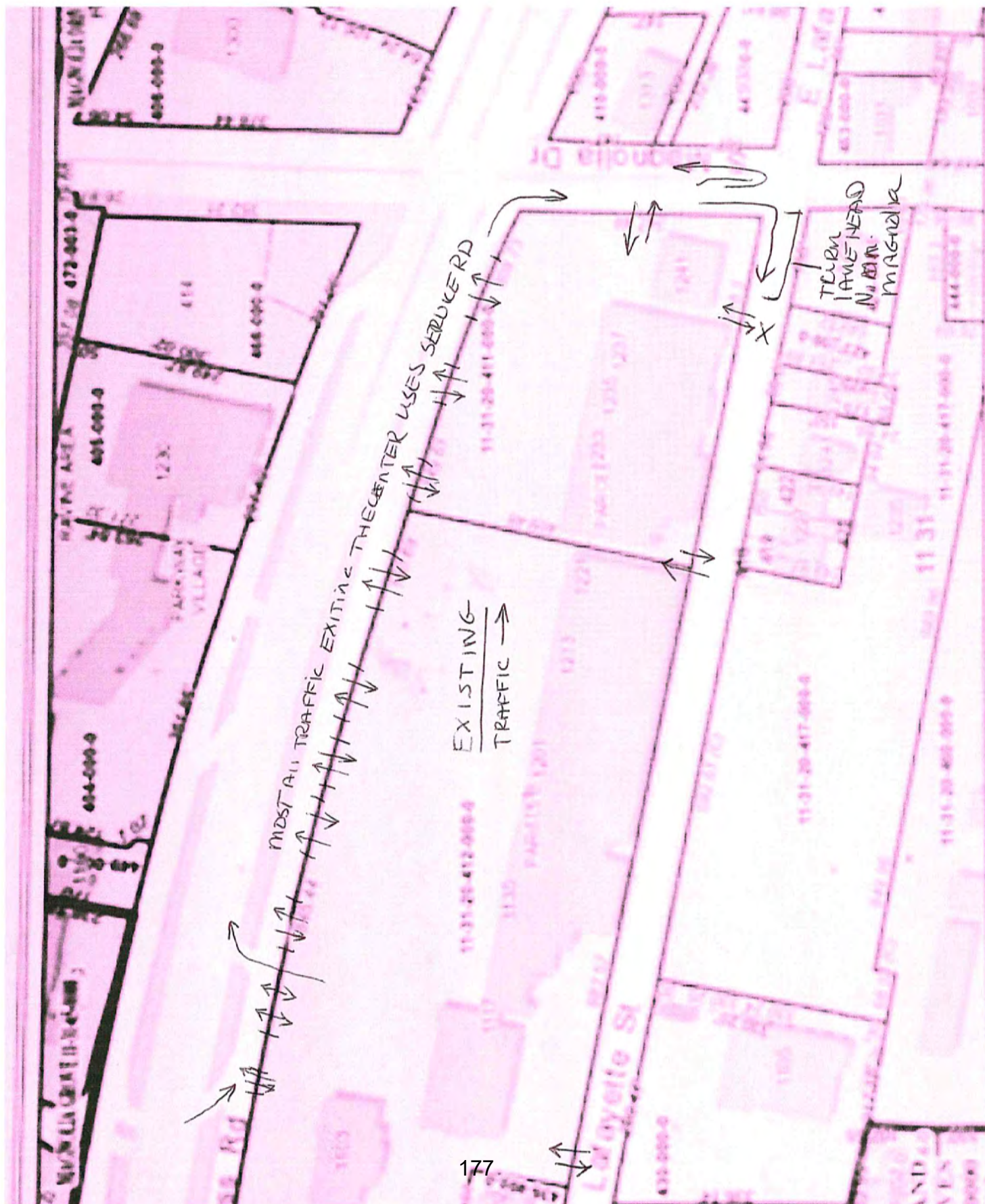

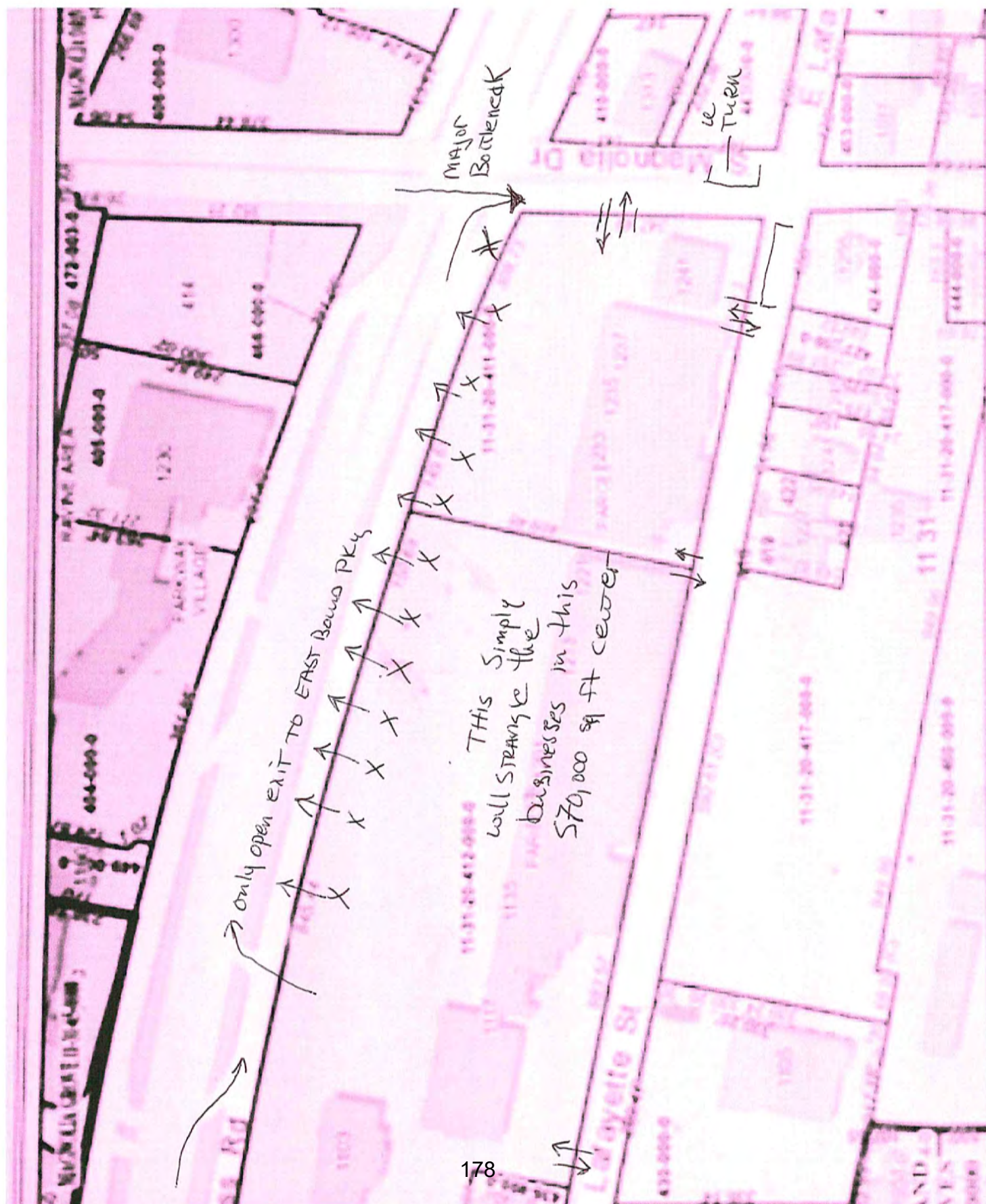

Magnolia Drive Multi-Use Trail Community Meeting South Monroe Street to Apalachee Parkway Design Review

Hartfield Elementary School
Cafeteria
1414 Chowkeebin Nene
Monday, November 6, 2017 5:30 p.m.

Please provide your comments below. If more space is needed, please use an additional sheet of paper. You may place your comments in the "Comment Box" provided at the meeting, or send to Susan Emmanuel at the address below by November 16, 2017. Emailed comments are also acceptable to Susan.Emmanuel@BlueprintIA.org. NOTICE: Comments submitted are a matter of public record subject to examination by the general public upon request.

THERE IS A BUS STOP AT THE NORTHEAST SIDE OF
MAGNOLIA & CHEROKEE. THERE HAVE BEEN INSTANCES WHERE
THE NEIGHBORS ARE UNEASY OF PEOPLE WHO HANG OUT AT
THE BUS STOP BECAUSE IT IS AT THEIR DRIVEWAY AND THEY
HAVE TEENAGE GIRLS. OUR PROPOSAL IS TO MOVE THE
BUS STOP TO THE SOUTHEAST CORNER BECAUSE IT IS
ON THE SIDE OF OUR HOUSE WITH NO ACCESS & IT WOULD
NOT DISTURB VS. TREES COULD BE TAKEN OUT AND A
BENCH W/FENCE COULD BE PUT UP. PLEASE CALL VS
TO DISCUSS. THANKS! GREAT ADDITION TO OUR
NEIGHBORHOOD.

GLENN & ELLEN DAVIS

Name

1227 CHEROKEE DR

Address

TALLAHASSEE, FL 32301

City, State, Zip

850-509-2421

Phone Number

DAVISEDG@GMAIL.COM

Email

Mail to:

Susan Emmanuel
Blueprint IA
315 S. Calhoun Street, Suite 450
Tallahassee, FL 32301

RE: Magnolia Dr. Multi-Use Trail

Susan Emmanuel

From: Julie B. Duggins <juliebduggins@gmail.com>
Sent: Friday, November 17, 2017 6:40 AM
To: Susan Emmanuel
Subject: Comments on Magnolia Drive Multi-Use Trail

Hi Susan,

Thanks for holding the public meeting about the Magnolia sidewalks. I hope my comments are not too late. Here is a condensed version:

- I think we all agree these sidewalks are a wonderful thing and sorely needed on Magnolia Drive.
- I like the middle plan, to add a small buffer from the street.
- I think it's important to keep the sidewalks wide and bikeable. The people who use these sidewalks to commute every day need them for transportation. I do not think these stakeholders were at the meeting (they were probably at work!). To make the sidewalks narrow and curvy would defeat the point of installing them.
- The more plantings the better! Franklin St. is a wonderful example of how to do the landscaping well.
- Installing trash cans might be a good idea, as I do pick up a lot of fast food bags on Sunday mornings.
- Sidewalks on Seminole Drive would also be great, and those could be narrow and have a buffer to the street.

Thanks again for listening!

Julie Duggins
2115 Seminole Drive (south Seminole and Magnolia)

Susan Emmanuel

From: Charles Hargraves
Sent: Wednesday, November 8, 2017 10:00 AM
To: denmaster3@gmail.com
Cc: Susan Emmanuel; Autumn Calder
Subject: RE: Suggestion for public meeting

Ms. Dannels,

We share your comments that a curvy walk or meandering trail is more interesting than a straight one. Great comments and we will incorporate them in our overall report as we move forward. Obviously there is no way to avoid all impacts, but our goal is to work to minimize impact and maximize the overall benefit.

Thank you very much for the time and input. As we mentioned we will have some follow-up meetings and we hope you will attend and participate in those as well.

Sincerely,

Charles

Blueprint Director • Blueprint Intergovernmental Agency
315 S. Calhoun St., Suite 450 • Tallahassee, FL 32301
850.219.1060
BlueprintIA.org

Florida has a very broad public records law. Most written communications to or from public offices are public records available to the public and media upon request. Your e-mail communications may be subject to public disclosure.

-----Original Message-----

From: denmaster3@gmail.com [mailto:denmaster3@gmail.com]
Sent: Tuesday, November 7, 2017 9:34 PM
To: Charles Hargraves
Cc: Susan Emmanuel; Autumn Calder
Subject: Re: Suggestion for public meeting

Thank you, Charles. I appreciate the time you took to respond, and I understand your reasoning. One concern I had last night was that people with very good ideas might not take the time to write them down (eg. the restaurant owner). I guess if it's important enough to them, they will.

I shared a brief description of the proposed designs and your e-mail addresses (the ones from the presentation) with the Indianhead-Lehigh neighborhood facebook page, so I hope more people will share their thoughts with you.

I am likely to walk the trail once it's complete, and the more trees you can preserve in the process, the more appealing it would be to me. In our neighborhood, sidewalks go around trees, and I don't mind the extra curves one bit. In fact, they make the walks more interesting.

I truly appreciate your reaching out for input from the people who will be impacted by this project. I can't imagine how I might feel if this were going through my front yard, so I hope you will pay extra attention to the people whose yards will be affected. I suspect they may have been under-represented at the meeting.

Thank you for reading my two cents. I'll let you know if I think of anything else significant.

Denise Dannels

Sent from my Verizon Wireless BlackBerry

-----Original Message-----

From: Charles Hargraves <charles.hargraves@Blueprintia.org>

Date: Tue, 7 Nov 2017 19:05:02

To: denmaster3@gmail.com<denmaster3@gmail.com>

Cc: Susan Emmanuel<susan.emmanuel@Blueprintia.org>; Autumn Calder<autumn.calder@Blueprintia.org>

Subject: RE: Suggestion for public meeting

Ms. Dannels,

The reason we ask for people to fill out the forms or to email us comments is it allows us to receive exactly the comments word for word that the person is sharing. The comments we received verbally will be incorporated/shared but there is some interpretation that goes when someone (other than a court reporter) is taking notes. Rest assured, the verbal comments will be memorialized to the extent that we are able to compile them.

I greatly appreciate your comment as it reminds me that we need to make certain we offer to those who may be unable/unwilling to write or email us comments, the opportunity for a staff person to take their comments and write it on their behalf. I will absolutely do my best to make certain we convey that in future meetings.

I am sorry it appeared that we were putting the burden of recording the comments on the citizen. We were simply trying to get as many comments as we can and to avoid information being lost in translation. Great feedback and much appreciated.

If you didn't take time to fill out a sheet, we would love it if you would share your comments, good, bad, or otherwise related to the project and any issues, concerns, positives that you have for the project. Please let us know and if practical, please let us know if you intend on using the trail or how the project might impact you personally.

Thank you for coming out last night and again we greatly appreciate the feedback.

Sincerely,

Charles Hargraves, P.E.

Blueprint Director * Blueprint Intergovernmental Agency
315 S. Calhoun St., Suite 450 * Tallahassee, FL 32301
850.219.1060
BlueprintIA.org

Florida has a very broad public records law. Most written communications to or from public offices are public records available to the public and media upon request. Your e-mail communications may be subject to public disclosure.

-----Original Message-----

From: denmaster3@gmail.com [mailto:denmaster3@gmail.com]

Sent: Monday, November 6, 2017 6:55 PM

To: Charles Hargraves

Subject: Suggestion for public meeting

Please consider assigning someone to take notes during the public discussion at the next meeting where you request public input on the Magnolia Drive Trail design project. During the meeting tonight, the facilitator kept telling people who were making comments to fill out a form. That shouldn't be necessary.

Denise Dannels

Sent from my Verizon Wireless BlackBerry

Susan Emmanuel

From: cbersok@nettally.com
Sent: Thursday, November 16, 2017 12:41 PM
To: Susan Emmanuel
Cc: Grant Gelhardt
Subject: magnolia drive multi-use sidewalk

Follow Up Flag: Follow up
Flag Status: Flagged

Thank you for the presentation at Hartsfield Elementary school on November 6. The information provided there is an important project update that is not currently shown on the webpage.

I have previously commented on the poor design that was actually implemented in Phase 1, along with its inherent problems of inappropriate vehicle use, and I appreciate the opportunity to comment on future phases.

I am strongly in favor of the design alternative with a 4 ft wide vegetation corridor between the pedestrian and bike users of the proposed sidewalk and the heavy motorized traffic of Magnolia Drive. Given that this appears to be feasible with an 8 ft-wide paved sidewalk, I heartily encourage that this design be pursued.

I would like to see the use of appropriate native plant species as part of that corridor.

Please keep me informed on the designs as they become more finalized. And please feel free to contact me if you have any questions about my comments.

Thank you

Connie Bersok

1905 East Indian Head Drive

850-590-6735

Magnolia Drive Multi-Use Trail Community Meeting
South Monroe Street to Apalachee Parkway
Design Review

Hartfield Elementary School
Cafeteria

1414 Chowkeebin Nene
Monday, November 6, 2017 5:30 p.m.

Please provide your comments below. If more space is needed, please use an additional sheet of paper. You may place your comments in the "Comment Box" provided at the meeting, or send to Susan Emmanuel at the address below by November 16, 2017. Emailed comments are also acceptable to Susan.Emmanuel@BlueprintIA.org. NOTICE: Comments submitted are a matter of public record subject to examination by the general public upon request.

1. I would prefer a 4' grass and 10' multi-use trail, even though it would take more of my property. I like the wide grass strip for safety as well as beauty.
2. We need some sort of traffic calming as there is aggressive, hostile speeding here 24-7. If nothing else perhaps one of those signs that tells your speed and the limit, then flashes 'Slow Down!'
3. Increased police monitoring of the dangerous speeding.

Thank You

Name John F. Valentine Address 1513 S. Magnolia Dr. City, State, Zip Tallahassee, FL 32301 Phone Number 850-878-3799 Email Valentine.jeff2@gmail.com		Mail to: Susan Emmanuel Blueprint IA 315 S. Calhoun Street, Suite 450 Tallahassee, FL 32301 RE: Magnolia Dr. Multi-Use Trail
---	--	---

BLUEPRINT
INTERGOVERNMENTAL AGENCY

Magnolia Drive Multi-Use Trail Community Meeting

South Monroe Street to Apalachee Parkway

Design Review

Hartfield Elementary School

Cafeteria

1414 Chowkeebin Nene

Monday, November 6, 2017 5:30 p.m.

Police hate to patrol the South side - per stmt from police we have spoken to

The street is used by motorcycle chists + cars to free at night

drive in yards!

I would like to 4' Buffer + 10' trail - otherwise, 4ft Buffer 8ft wider

Please provide your comments below. If more space is needed, please use an additional sheet of paper. You may place your comments in the "Comment Box" provided at the meeting, or send to Susan Emmanuel at the address below by November 16, 2017. Emailed comments are also acceptable to Susan.Emmanuel@BlueprintIA.org. NOTICE: Comments submitted are a matter of public record subject to examination by the general public upon request.

very concerned about \$ (funds) for the Magnolia project. I absolutely believe there must be a 4ft buffer between the road and the trail. I am concerned aggressive drivers will drive upon the trail in order to pass people. Trying to get out of my driveway is a nightmare. We never back out and use 50% of the front yard to turn around. There must be a buffer or a "pause" to allow people to

"think" about where they are, and what they are doing. Over the past 20 years there have been multiple crashes in front of the house. I am a bicycle enthusiast and I would not ride on Magnolia ever. I tried once. I have to drive my bike to another area and then begin my ride. I wonder if the city could come up with \$450,000 if the trail were being placed on McClay Blvd to allow ambulatory + biking to connect Meridian @ McClay School?

Name Leslie Valentine
Address 1813 S Magnolia Dr
City, State, Zip Tallahassee FL 32301
Phone Number 850 878 3799
Email parkingcrown@comcast.net

Mail to:
Susan Emmanuel
Blueprint IA
315 S. Calhoun Street, Suite 450
Tallahassee, FL 32301
RE: Magnolia Dr. Multi-Use Trail
REC'D BLUEPRINT IA
NOV 15 17 AM 8:29

Must put in 11' curb 40 mph => 5/10w



Tameeka Williams

From: Susan Emmanuel
Sent: Monday, November 27, 2017 11:41 AM
To: Tameeka Williams
Subject: FW: Magnolia Drive Multi-Use Trail Concerns

From: ecosta52@comcast.net [mailto:ecosta52@comcast.net]
Sent: Tuesday, November 14, 2017 9:07 AM
To: Susan Emmanuel <susan.emmanuel@Blueprintia.org>
Cc: ecosta52@comcast.net
Subject: Fwd: Magnolia Drive Multi-Use Trail Concerns

From: ecosta52@comcast.net
To: "susan emmanuel" <susan.emmanuel@blueprintia.org>
Cc: ecosta52@comcast.net
Sent: Tuesday, November 14, 2017 8:45:42 AM
Subject: Magnolia Drive Multi-Use Trail Concerns

Dear Susan,

We live at 1104 E. Magnolia Drive and below are our concerns regarding the Multi-Use Trail.

1. The noise pollution generated by the proposed traffic light will only increase due to the traffic coming to a complete standstill in front of our home.
2. Please install the pedestrian crossing away from our driveway (not sure of the proposed location)
3. The established shrubberies in front of our home provide privacy and a noise barrier from traffic which we will lose if they are removed. The shrubberies also keep car lights from shining directly into our home. How can we be assured that an alternative barrier will provide us privacy and reduce noise from the road traffic if these shrubberies are removed.
4. Please find a way to slow down traffic on Magnolia Drive.
5. Can semi trucks be rerouted from Magnolia Drive?

Thank you.

Willie and Elaine Costa

Tameeka Williams

From: Susan Emmanuel
Sent: Monday, November 27, 2017 11:40 AM
To: Tameeka Williams
Subject: FW: Magnolia comments deadline?

-----Original Message-----

From: Edward Reid [mailto:edward@paleo.org]
Sent: Monday, November 13, 2017 1:41 PM
To: Susan Emmanuel <susan.emmanuel@Blueprintia.org>
Subject: Magnolia comments deadline?

Hi Susan,

I forget -- what's the deadline for comments on the Magnolia project?

I'm very upset that apparently no planner has even looked at the AASHTO bicycle guide (technically the Guide for the Development of Bicycle Facilities, 4th edition), much less paid the slightest attention to my comments based on AASHTO recommendations. I cannot comprehend road planners ignoring AASHTO. Do I have to buy my own copy (\$203) so that I can knock people over the head with it?

https://bookstore.transportation.org/item_details.aspx?ID=1943

To make it clear, I do not care whether Magnolia Drive from Jim Lee Road to Apalachee Parkway gets any additional bicycle facilities. I ride on the existing road when necessary, and in this area numerous alternatives are available.

My primary interest is avoiding the construction (and waste of money) on a facility which claims to benefit bicyclists but in fact is extremely dangerous for bicycle use, as demonstrated by many studies and statistics.

In fact, probably the greatest benefit to bicyclists in the remainder of the project will result from the sidewalk (stop calling it a "trail"; it's not) at Toochin Nene. Currently turning from Toochin onto Magnolia is difficult because of the slope; the sidewalk will result in a level space short of the road.

Edward

Tameeka Williams

From: Susan Emmanuel
Sent: Monday, November 27, 2017 11:39 AM
To: Tameeka Williams
Subject: FW: MAGNOLIA DRIVE MULTI-USE TRAIL PROJECT

-----Original Message-----

From: Barry Toohey [mailto:BEToohey@comcast.net]
Sent: Monday, November 13, 2017 10:08 AM
To: Susan Emmanuel <susan.emmanuel@Blueprintia.org>
Subject: MAGNOLIA DRIVE MULTI-USE TRAIL PROJECT

To Who It May Concern;

The following are concerns that my wife and I have about phase 2A of the project.

1. When the light is put in at the corner of Jim Lee and Magnolia, a few problems are going to be magnified that we are already experiencing at this corner.
 - a. The trash that is thrown out of vehicles at this corner, will double if not more, now that the vehicles are stopping at the new light and just not driving by.
 - b. The the noise level is going to go up for the same reason, now that the vehicles are stopping on both streets at this corner and not just Jim Lee.
 - c. When Jim Lee is straightened for the new light at the corner, the vehicle lights will than shine in the neighbors house across the street.
2. Other issues that we are going to have with the trail are as follows.
 - a. The walking trail that is going to be right on our property line will allow people to throw trash onto our property even easier than they do now. The road is about 16 feet away now when the trail is put in it will be about two feet away.
 - b. The azaleas that I planted along our property line on Magnolia to help combat the noise and trash problem are in the plans to be removed by the project. It took eight years to grow those azaleas and the cost of the plant and maintenance of those plants will be lost to us.
 - c. Our privacy will be lost since our front door and porch are on the Magnolia side of the house.
 - d. When they straighten the corner on Jim Lee at the light, we have left a brush and tree buffer on that side of the house but if that is removed than we will have the same problems on that side of the house that we are going to have on the Magnolia side of the house.
3. We would like to see a wall of some type put up along the property line to combat the trash, noise, and light pollution that will be caused by the project.
4. Please note that none of your plans or maps at the meeting held at Hartsfield Elementary School on 6 November 2017, even showed our house located at 2101 Cheeke Nene (the corner of Jim Lee and Magnolia). I think this is

important since our home is so close to both roads it is being overlooked by the planners since they don't see it on the maps or plans.

4. We support the walking trail for safety reasons and the betterment of the community, but do not believe it should be at a cost to our privacy and comfort in our own home and yard. We also believe that due to the items listed above this will affect any re-sell of our home in the future. All we are asking at this point would you want this to happen to your home without some reassurances?

5. Thank you for your time and consideration in this matter.

Barry Toohey
2101 Cheeke Nene
Tallahassee Fl, 32301

Tameeka Williams

From: Susan Emmanuel
Sent: Monday, November 27, 2017 11:42 AM
To: Tameeka Williams
Subject: FW: Magnolia and the Parkway proposed changes

From: Charles Hargraves
Sent: Tuesday, November 7, 2017 3:44 PM
To: Mike Ferrara <cabos_tacos@yahoo.com>
Cc: Susan Emmanuel <susan.emmanuel@Blueprintia.org>; Cherie Bryant <Cherie.Bryant@talgov.com>; hhodge@pecscorp.com; ian.satter@dot.state.fl.us; Suzanne Lex (Suzanne.Lex@dot.state.fl.us) <Suzanne.Lex@dot.state.fl.us>
Subject: RE: Magnolia and the Parkway proposed changes

Mr. Ferrara,

It was a pleasure meeting you and hearing your concerns. I am hopeful that you will hear from the Department on their improvements and maybe some will lead to improvements either on the Department side or the development side to improve access and safety in your area.

Thanks again for the input and outreach.

Sincerely,

Charles

Blueprint Director • Blueprint Intergovernmental Agency
315 S. Calhoun St., Suite 450 • Tallahassee, FL 32301
850.219.1060
BlueprintIA.org



Florida has a very broad public records law. Most written communications to or from public offices are public records available to the public and media upon request. Your e-mail communications may be subject to public disclosure.

From: Mike Ferrara [mailto:cabos_tacos@yahoo.com]
Sent: Monday, November 6, 2017 6:23 PM
To: Charles Hargraves

Cc: Susan Emmanuel; Cherie Bryant; hhodge@pecscorp.com; ian.satter@dot.state.fl.us; Suzanne Lex (Suzanne.Lex@dot.state.fl.us)

Subject: Re: Magnolia and the Parkway proposed changes

I operate a restaurant and unfortunately I simply couldn't get away from work to attend to voice my concerns. All those that you referenced have received an email voicing my concerns .

Thanks so much for responding

Mike Ferrara

Sent from my iPhone

On Nov 6, 2017, at 4:11 PM, Charles Hargraves <charles.hargraves@Blueprintia.org> wrote:

Mr. Ferrara,

Attached is the information flier we received at the Public Hearing held by the Florida Department of Transportation (Department) the Thursday (Oct. 26th). The intersection improvements being proposed I believe are primarily being made to address safety at the intersection. Blueprint's interest in the intersection improvements proposed by the Department is our desire to incorporate adjustments along Magnolia Drive to accommodate the future addition of a multiuse trail along the west side of Magnolia Drive.

While we appreciate your position and concerns, we believe that the Department is in a better position to address or respond to your concerns. In the end, we all have the common goals of providing a safe transportation corridor (vehicular, pedestrians, bicyclists, etc.) while maintaining good ingress/egress to surrounding businesses.

Mr. Howard Hodge is the Department's Project Manager. His email is hhodge@pecscorp.com and his phone number is (850) 526-2291. The Department's Public Information Director was also listed as a contact point and his name is Ian Satter. His email address is ian.satter@dot.state.fl.us and his phone number is (888) 638-0250, ext. 1208. I am copying both to make sure they receive your concern as quickly as possible.

I hope this helps connect you to the appropriate point of contact to address your concerns.

Sincerely,

Charles Hargraves, P.E.

Blueprint Director • Blueprint Intergovernmental Agency
315 S. Calhoun St., Suite 450 • Tallahassee, FL 32301
850.219.1060
BlueprintIA.org

<image003.png>

Florida has a very broad public records law. Most written communications to or from public offices are public records available to the public and media upon request. Your e-mail communications may be subject to public disclosure.

From: Mike Ferrara [mailto:cabos_tacos@yahoo.com]

Sent: Friday, November 3, 2017 11:53 AM

To: Charles Hargraves; Cherie Bryant

Subject: Fw: Fwd: Magnolia and the Parkway proposed changes

Thanks Cherie
Mike

Mr Hodge,
Thanks so much for taking my call this morning.

My solution would be to place the stop sign back before the exit was closed off at the service road at the junction of S. Magnolia and reopen the the turn lane in the eastbound lane off the Parkway.

I also feel that the number of accidents at the intersection is due to inadequate signage alerting people that there is a service road.

If you dont live here, missing that exit isn't too difficult to imagine... The pileup of folks trying to enter the shopping center in the southbound lane of Magnolia also plays a huge part in accidents at the intersection...

This issue is compounded by South Magnolia merging into one lane at Lafayette...

.I can imagine the problems that are going to ensue when folks that took the easy way out of the center utilizing the service road will be when they are stuck with the entrance/exit onto South magnolia .

What will happen is people will stop doing business at the center and go where getting in and out won't be an issue.. Please rethink this.

<SR 29 at SR 265 Intersection Improvements.pdf>